

Pavement Licensing Policy

1. Introduction

The Business and Planning Act 2020 (as amended) was introduced as temporary legislation to assist businesses and remove existing bureaucracy around what were known as Tables and Chairs Licences under the Highways Act. The Business and Planning Act 2020 has now been amended by the Levelling Up and Regeneration Act 2023 which makes the Pavement Licence regime permanent.

The Act allows Chelmsford City Council to permit specified furniture to be placed on the highway (mostly footpaths and pedestrianised areas) although where applicable, businesses may still need the activity to be licensed, for example, sale of alcohol.

2. Definition of ‘pavement licence’

A pavement licence is a licence granted by the local authority, or deemed to have been granted, which allows the licence holder to place removable furniture over certain highways adjacent to the premises in relation to which the application was made, and for certain purposes.

3. Eligible Businesses

A person (which includes a body corporate) which uses (or proposes to use) premises for the sale of food or drink for consumption (on or off the premises) can apply for a licence. Businesses that are eligible include: public houses, cafes, bars, restaurants, snack bars, coffee shops, ice cream parlours or similar.

A licence permits the business to use furniture placed on the highway in order to sell or serve food or drink and/or allow it to be used by people for consumption of food or drink supplied from, or in connection with the use of the premises.

A pavement licence does not licence the activity, only the placing of the furnishings. The pavement licence is issued to a person or incorporated body. Where there is a change to that person or incorporated body then the licence will lapse, and a further application will need to be made by any new person.

4. Eligible Locations

Licences can only be granted in respect of highways listed in section 115A(1) Highways Act 1980.

Generally, these are footpaths restricted to pedestrians or are roads and places to which vehicle access is restricted or prohibited. Highways maintained by Network Rail or over the Crown land are exempt (so a licence cannot be granted).

This policy is applicable throughout the Chelmsford City Council district, although its main impact is within the city centre as other areas with demand for tables and chairs tend to be on privately owned land.

From 8 High Street northwards to the top of the High Street tables and chairs are only permitted in the hatched areas of the plan at Appendix 1. There must be a minimum width of 3 metres between the business façade and the tables and chairs, and a minimum 5 metre clear route along the centre of the street. The maximum depth of the area licensed for tables and chairs to be 2.5 metres.

To the south of 8 High Street, including Springfield Road and Moulsham Street, tables and chairs to be placed abutting the façade. The maximum depth of the area licensed for tables and chairs is to be 2.5 metres. Maximum depth of 2.5 metres does not apply to Exchange Square or Backnang Square.

Tables and chairs can only be placed in front of the façade the licence holder is responsible for.

Tables and Chairs will not be permitted where they would restrict any pedestrianised public highway to less than 2.5 metres in width or impede any designated cycle route.

Any application for tables and chairs in front of Shire Hall must be considered by the Council's Regulatory Committee.

5. Type of furniture permitted

Seating, tables and, if required, umbrellas and heaters (together with a secure base) as well as any proposed barriers to enclose the seating area are permitted.

The furniture must be fit for purpose and designed specifically for commercial outdoor use (and comply with all relevant BS standards). It must be kept in good order; damaged or faded items must be replaced.

This furniture is required to be removable, meaning that it is not a permanent fixed structure, and is able to be moved easily, and should be stored away when the premises are closed for activity.

There is an expectation that the type and style of furniture would be 'in keeping' with the local area.

Picnic benches and plastic tables and chairs designed for domestic use (e.g. white plastic furniture) are not permitted.

Any form of gazebo or enclosed shelter with one or more sides is not permitted.

6. Barriers

When tables and chairs are in place a standard barrier consisting of a fabric banner and associated post/rail system shall be used. The function of the barriers is to demarcate and contain the tables and chairs but also to give a clear warning particularly to people with visual impairments.

The barriers shall be secured by a purpose designed post and rail system with weighted post bases to prevent being knocked or blown over and be of a height range of 800mm to 1000mm so to not visually obstruct views down the street or be an obstructing hazard

Street café barriers should be of a design to complement the character of the surrounding area. Banners should be of one design, in a plain style and can incorporate the business name or brand logo. Posts and rails should be stainless steel, chrome plated or powder coated.

7. Times of Operation

The tables and chairs can be placed on the highway only when the premises are open for business and in any event not before 6.00 am and normally until the close of business.

Where nuisance is likely to be caused to residents e.g. late at night, businesses may be required to remove the tables and chairs before the close of business.

8. Planning Permission

Once a licence is granted the applicant will also benefit from deemed planning permission to use the land for anything done only pursuant to the licence while the licence is valid, but not for any other purpose.

9. Consultation

Applications are consulted upon for 14 days, starting with the day after that on which the application is made to the Council (an application will not be considered to have been properly made unless each requirement has been met).

The Council will publish details of the application on its website at www.chelmsford.gov.uk/business/licensing/find-a-licence/pavement-licence

The Council is required by law to consult with the Essex County Council Highways Authority. In addition, to ensure that there are no detrimental effects in granting such a licence the Council will also consult with:

- Chelmsford City Council Environmental Health Service
- Chelmsford City Council Planning Department
- Essex Police
- The appropriate Local Ward Councillor(s)
- The appropriate Parish or Town Council

Members of the public and others listed above can contact the Council to make representations.

The Council must take into account representations received during the public consultation period and consider in their determination of the application.

10. Cost

There is an application fee and a renewal fee payable every two years. Details can be found on the application form and Chelmsford City Council website.

11. Insurance

Operators must indemnify both Chelmsford City Council and Essex County Council in respect of injury, damage or loss arising out of the grant of permission (unless such claims arise out of the Councils' negligence). All operators must have public liability insurance in the sum of £10,000,000 in respect of any one event. A copy of this insurance must be produced to the Council before a licence will be issued.

The Licence holder shall make no claim or charge against the Council in the event of the furniture or other objects being lost, stolen or damaged in any way.

12. Litter

Refuse and litter deposited on the highway in the vicinity of the chairs and tables must be collected at not less than hourly intervals (or more frequent intervals if required under the Environmental Protection Act 1990).

Litter is not to be placed in the litter bins situated on the highway for use by the general public, but in the trade refuse bins.

All tables must be cleared as soon as practicable after being vacated by customers to avoid litter being deposited unnecessarily on the highway.

13. Miscellaneous Conditions

The Licence holder must remove any furniture if required to do so to permit works in or the use of the highway by the Council, the County Council, the emergency services any statutory undertaker or telecommunications code operator or where the Licence holder has been notified of a special event taking place.

No charge can be made by the Licence holder for the use of the furniture.

All licences are renewable every two years.

Appendices

Appendix 1

Map of Chelmsford City High Street with permitted areas for tables and chairs

Creation date	Version No.	Changes Approved:
June 2024	2	Policy updated to include legislative changes, adopt new and renewal fees and take into account decision of regulatory committee on 17/3/2022 to introduce specific restrictions in Chelmsford Town Centre

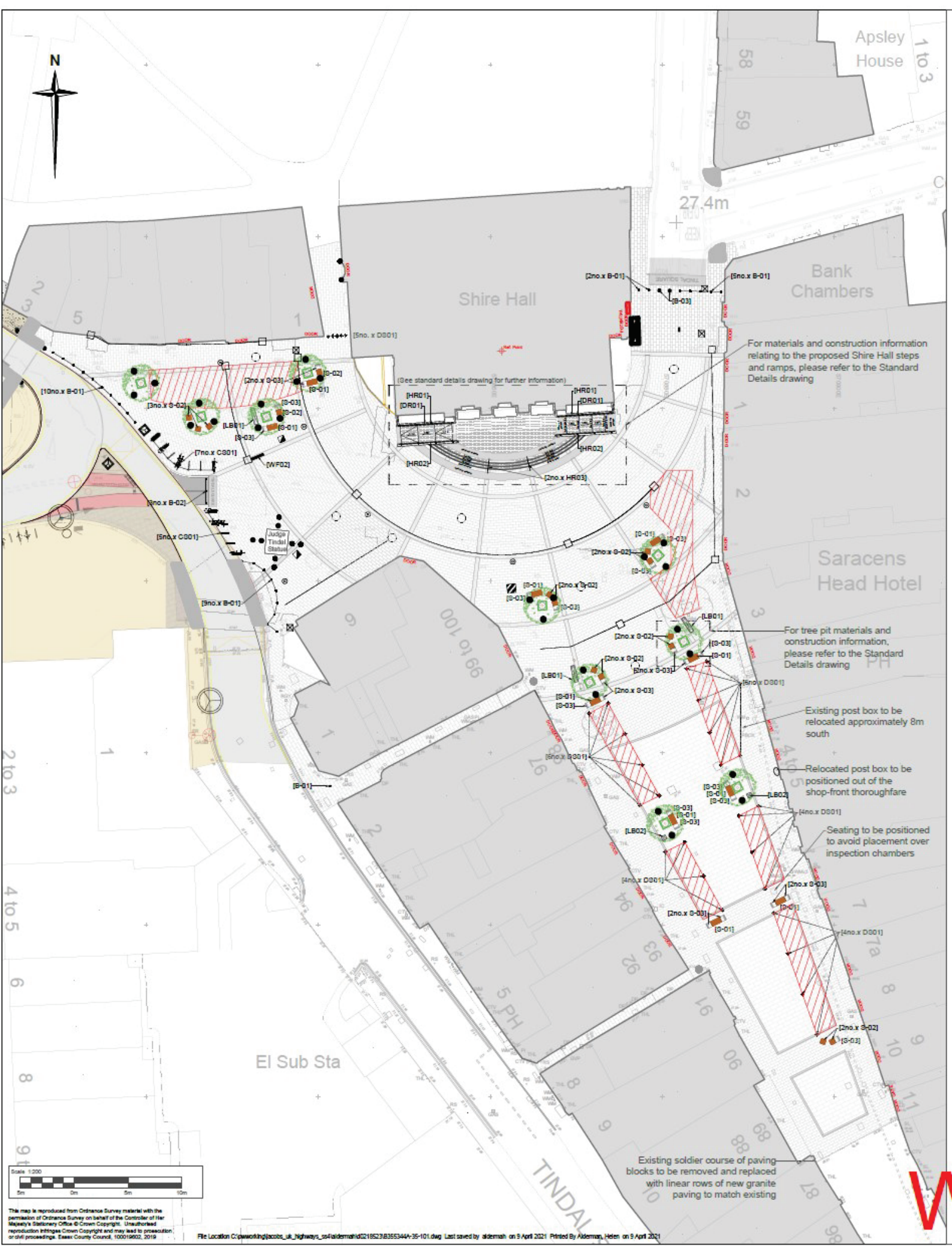

27.4m

Apsley House
1 to 3

58
59

Bank Chambers

Shire Hall

For materials and construction information relating to the proposed Shire Hall steps and ramps, please refer to the Standard Details drawing

(See standard details drawing for further information)

Saracens Head Hotel

For tree pit materials and construction information, please refer to the Standard Details drawing

Existing post box to be relocated approximately 8m south

Relocated post box to be positioned out of the shop-front thoroughfare

Seating to be positioned to avoid placement over inspection chambers

Existing soldier course of paving blocks to be removed and replaced with linear rows of new granite paving to match existing



This map is reproduced from Ordnance Survey material with the permission of Ordnance Survey on behalf of the Controller of Her Majesty's Stationery Office © Crown Copyright. Unauthorised reproduction infringes Crown Copyright and may lead to prosecution or civil proceedings. Essex County Council, 100019602, 2019

